

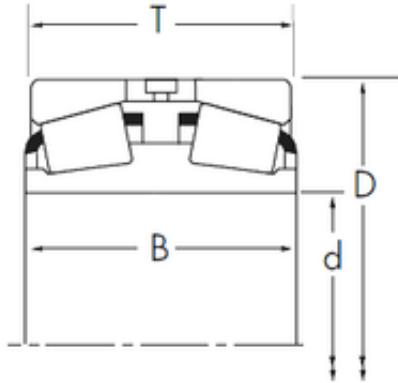

## AMERICAN BEARING MFG.CORP.



85,725 mm x 123,825 mm x 44,45 mm Timken  
L217845D/L217810+L217810EA tapered roller  
bearings

Bearing No. L217845D/L217810+L217810EA

Size	85.725x123.825x41.278 mm
Bore Diameter	85,725 mm
Outer Diameter	123,825 mm
Width	41,278 mm
d	85,725 mm
D	123,825 mm
T	41,278 mm
B	44,45 mm
R	0,8 mm
r	1,5 mm

L217845D/L217810+L217810EA Bearing 2D drawings  
and 3D CAD models