

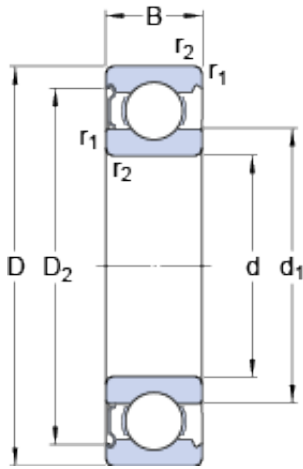

AMERICAN BEARING MFG.CORP.



100 mm x 150 mm x 24 mm SKF 6020-Z deep groove ball bearings

Bearing No. 6020-Z

6020-Z Bearing 2D drawings and 3D CAD models

Size	150x100x24 mm
Bore Diameter	150 mm
Outer Diameter	100 mm
Width	24 mm
d	100 mm
D	150 mm
B	24 mm
d ₁	115.95 mm
D ₂	138.3 mm
r _{1,2} - min.	1.5 mm
d _a - min.	107 mm
d _a - max.	115.9 mm
D _a - max.	143 mm
r _a - max.	1.5 mm
Basic dynamic load rating - C	63.7 kN
Basic static load rating - C ₀	54 kN
Fatigue load limit - P _u	2 kN
Reference speed	9500 r/min
Limiting speed	5600 r/min
Calculation factor - k _r	0.025
Calculation factor - f ₀	15.9
Category	Single Row Ball Bearings
Inventory	0.0
Manufacturer Name	SKF



AMERICAN BEARING MFG.CORP.

Minimum Buy Quantity	N/A
Weight / Kilogram	1.306
Product Group	B00308
Enclosure	1 Metal Shield
Precision Class	ABEC 1 ISO P0
Maximum Capacity / Filling Slot	No
Rolling Element	Ball Bearing
Snap Ring	No
Internal Special Features	No
Cage Material	Steel
Internal Clearance	C0-Medium
Inch - Metric	Metric
Long Description	100MM Bore; 150MM Outside Diameter; 24MM Outer Race Diameter; 1 Metal Shield; Ball Bearing; ABEC 1 ISO P0; No Filling Slot; No Snap Ring; No Internal Special Features
Category	Single Row Ball Bearing
UNSPSC	31171504
Harmonized Tariff Code	8482.10.50.68
Noun	Bearing
Keyword String	Ball
Manufacturer URL	http://www.skf.com
Manufacturer Item Number	6020 Z
Weight / LBS	2.9
Bore	3.937 Inch 100 Millimeter
Outside Diameter	5.906 Inch 150 Millimeter
Outer Race Width	0.945 Inch 24 Millimeter
bore diameter:	100 mm
static load capacity:	54 kN
outside diameter:	150 mm



AMERICAN BEARING MFG.CORP.

precision rating:	ABEC 1 (ISO Class Normal)
overall width:	24 mm
finish/coating:	Uncoated
bore type:	Round
cage material:	Steel
closure type:	Single Shield
outer ring width:	24 mm
row type & fill slot:	Single Row Non-Fill Slot
fillet radius:	1.5 mm
internal clearance:	C0
maximum rpm:	4500 RPM
dynamic load capacity:	63.7 kN
series:	60
d_1	115.95 mm
D_2	138.3 mm
$r_{1,2}$ min.	1.5 mm
d_a min.	107 mm
d_a max.	115.9 mm
D_a max.	143 mm
r_a max.	1.5 mm
Basic dynamic load rating C	63.7 kN
Basic static load rating C_0	54 kN
Fatigue load limit P_u	2.04 kN
Calculation factor k_r	0.025
Calculation factor f_0	15.9
Mass bearing	1.28 kg