

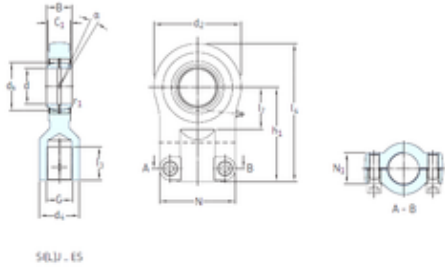

# AMERICAN BEARING MFG.CORP.

## SKF SIJ20ES plain bearings



Bearing No. SIJ20ES

Bore Diameter	20 mm
d	20 mm
d2	55 mm
d4 max.	25 mm
dk	29 mm
h1	58 mm
l3 min.	19 mm
l4 max.	85,5 mm
l7 min.	25 mm
r1 min.	0,3 mm
B	16 mm
C1 max	13 mm
N max	55 mm
N1 max	17 mm
Thread (G)	M14x1,5 Tolerance 6H
Angle	3 °
Weight	0,4 Kg
Basic dynamic load rating (C)	30 kN

SIJ20ES Bearing 2D drawings and 3D CAD models