

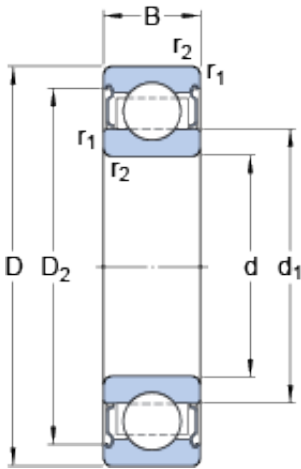

AMERICAN BEARING MFG.CORP.



110 mm x 170 mm x 28 mm SKF
6022-2Z/VA208 deep groove ball bearings

Bearing No. 6022-2Z/VA208

6022-2Z/VA208 Bearing 2D drawings and 3D CAD models

Size	170x110x28 mm
Bore Diameter	170 mm
Outer Diameter	110 mm
Width	28 mm
d	110 mm
D	170 mm
B	28 mm
d ₁	129.05 mm
D ₂	155.3 mm
r _{1,2} - min.	2 mm
d _a - min.	119 mm
d _a - max.	128.9 mm
D _a - max.	161 mm
r _a - max.	2 mm
Basic dynamic load rating - C	85.2 kN
Basic static load rating - C ₀	73.5 kN
Limiting speed	30 r/min
Limiting temperature - T	350 ° C
Category	Single Row Ball Bearings
Inventory	0.0
Manufacturer Name	SKF
Minimum Buy Quantity	N/A
Weight / Kilogram	0
Product Group	B00308



AMERICAN BEARING MFG.CORP.

Enclosure	2 Metal Shields
Precision Class	ABEC 1 ISO P0
Maximum Capacity / Filling Slot	No
Rolling Element	Ball Bearing
Snap Ring	No
Internal Special Features	Segmented Cage
Cage Material	Graphite
Internal Clearance	C0-Medium
Inch - Metric	Metric
Long Description	110MM Bore; 170MM Outside Diameter; 28MM Outer Race Width; 2 Metal Shields; Ball Bearing; ABEC 1 ISO P0; No Filling Slot; No Snap Ring; Segmented Cage Internal Special Features; C0-Medium Internal C
Other Features	Deep Groove Extreme Temperature Variant
Category	Single Row Ball Bearing
UNSPSC	31171504
Harmonized Tariff Code	8482.10.50.68
Noun	Bearing
Keyword String	Ball
Manufacturer URL	http://www.skf.com
Weight / LBS	2.05
Inner Race Width	0 Inch 0 Millimeter
Bore	4.331 Inch 110 Millimeter
Outer Race Width	1.102 Inch 28 Millimeter
Outside Diameter	6.693 Inch 170 Millimeter
d ₁	129.05 mm
D ₂	155.3 mm
r _{1,2} min.	2 mm



AMERICAN BEARING MFG.CORP.

d_a min.	119 mm
d_a max.	128.9 mm
D_a max.	161 mm
r_a max.	2 mm
Basic dynamic load rating C	85.2 kN
Basic static load rating C_0	73.5 kN
Limiting temperature T max.	350 ° C
Mass bearing	2.06 kg