

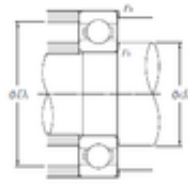

# AMERICAN BEARING MFG.CORP.

20 mm x 52 mm x 15 mm NTN 6304LLU deep groove ball bearings

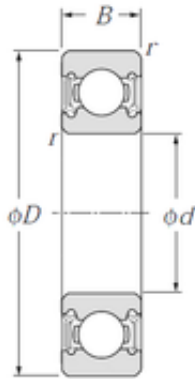

Bearing No. 6304LLU

6304LLU Bearing 2D drawings and 3D CAD models

Size	20x52x15 mm
Bore Diameter	20 mm
Outer Diameter	52 mm
Width	15 mm
d	20 mm
D	52 mm
B	15 mm
C	15 mm
r min.	1,1 mm
da min.	26,5 mm
da max	28,5 mm
Da max.	45,5 mm
ra max.	1 mm
Weight	0,144 Kg
Basic dynamic load rating (C)	15,9 kN
Basic static load rating (C0)	7,9 kN
Reference speed	10 000 r/min
Category	Single Row Ball Bearings
Inventory	0.0
Manufacturer Name	NTN
Minimum Buy Quantity	N/A
Weight / Kilogram	0.145
Product Group	B00308
Enclosure	2 Seals
Precision Class	ABEC 1   ISO P0



## AMERICAN BEARING MFG.CORP.

Maximum Capacity / Filling Slot	No
Rolling Element	Ball Bearing
Snap Ring	No
Internal Special Features	No
Cage Material	Steel
Enclosure Type	Contact Seal
Internal Clearance	C0-Medium
Inch - Metric	Metric
Long Description	20MM Bore; 52MM Outside Diameter; 15MM Outer Race Width; 2 Seals; Ball Bearing; ABEC 1   ISO P0; No Filling Slot; No Snap Ring; No Internal Special Features; C0-Medium Internal Clearance; Steel Cage;
Other Features	Deep Groove   Double Lip Friction Nitrile Rubber Seal   -20 To 120 Deg C
Category	Single Row Ball Bearing
UNSPSC	31171504
Harmonized Tariff Code	8482.10.50.68
Noun	Bearing
Keyword String	Ball
Manufacturer URL	<a href="http://www.ntnamerica.com">http://www.ntnamerica.com</a>
Manufacturer Item Number	6304LLU
Weight / LBS	0.317
Outer Race Width	0.591 Inch   15 Millimeter
Bore	0.787 Inch   20 Millimeter
Outside Diameter	2.047 Inch   52 Millimeter
Inner Race Width	0 Inch   0 Millimeter
bore diameter:	20 mm
precision rating:	ISO Class 0



## AMERICAN BEARING MFG.CORP.

outside diameter:	52 mm
finish/coating:	Uncoated
overall width:	15 mm
bearing material:	High Carbon Chrome Steel
bore type:	Round
cage material:	Steel
closure type:	Double Sealed
inner ring width:	15 mm
row type & fill slot:	Single Row Non-Fill Slot
outer ring width:	15 mm
snap ring included:	Without Snap Ring
maximum rpm (grease):	10000 rpm
internal clearance:	CN
fillet radius:	1.1 mm
operating temperature range:	-40 to 120 ° C
maximum rpm:	17000 RPM
dynamic load capacity:	15900 N
series:	63
static load capacity:	7900 N
manufacturer product page:	<a href="#">Click here</a>