

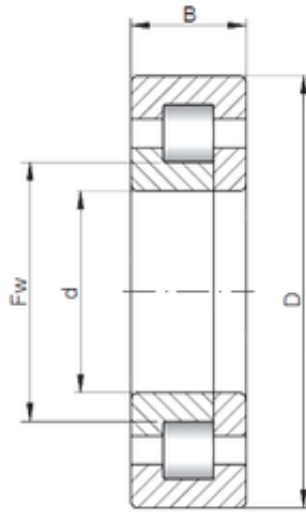

## AMERICAN BEARING MFG.CORP.



600 mm x 870 mm x 118 mm ISO NUP10/600  
cylindrical roller bearings

Bearing No. NUP10/600

Size	600x870x118 mm
Bore Diameter	600 mm
Outer Diameter	870 mm
Width	118 mm
d	600 mm
D	870 mm
B	118 mm
C	118 mm

NUP10/600 Bearing 2D drawings and 3D CAD models